

izi Sleep Isofix™

REARWARD-FACING

USER MANUAL



ECE R44 04

GROUP
0+

WEIGHT
0-13 kg

AGE
0-12 m



BeSafe®

Thank you for choosing BeSafe iZi Sleep ISOfix

BeSafe has developed this seat with much care, to protect your child during the first phase of her or his life.



It is important that you read this user manual BEFORE installing your seat. Incorrect installation could endanger your child.

Contents

Vital information	3
Preparing to install	4
iZi Sleep ISOfix usage	5
ISOfix installation	6
Removing iZi Sleep ISOfix	10
Warning: potential misuse	13
Important advice	14
Point of sale information	15
Guarantee	16

Vital information



- It is **NOT ALLOWED** to mount the seat in a front passenger seat **WITH AN ACTIVATED AIRBAG**.
- iZi Sleep ISOfix can only be installed rearward-facing with the ISOfix anchorage in a car equipped with ISOfix anchorage points.
- iZi Sleep ISOfix is approved in group 0+, rearward-facing from 0-13 kg.
- The floor support must always be used. Make sure that the floor support is fully pushed down.
- The child shall always be secured with the internal harness belts when seated in the child seat, also by carrying and when used in combination with a push chair.
- When installed with ISOfix: Make sure the indicators are green before you drive.
- When the child weighs over 13 kg or the shoulder height grows above the highest position of the shoulder straps, the child must change to a group 1 seat.
- **DO NOT** use the iZi Sleep ISOfix in sleeping position when installed in your car.
- After an accident, the seat must be replaced. Although it may look undamaged, if you were to have another accident, the seat may not be able to protect your child as well as it should.

Preparing to install

Crucial parts

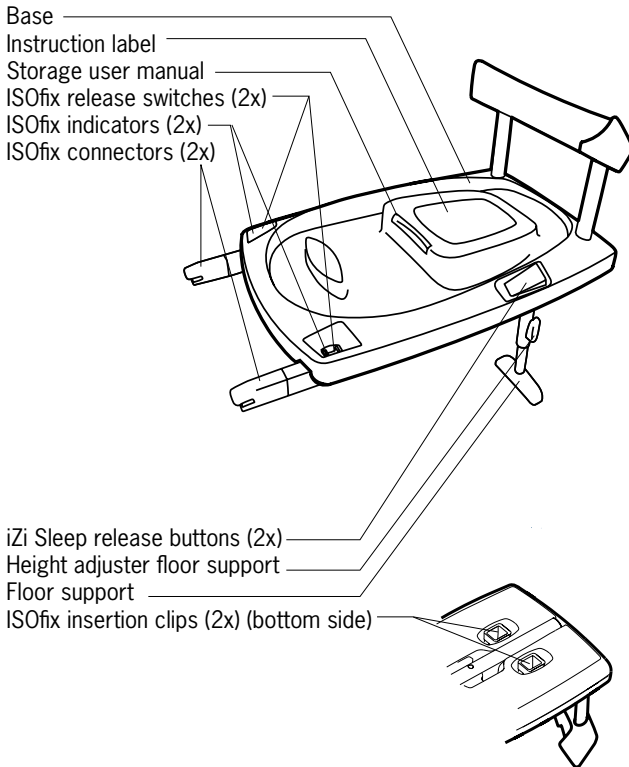

iZi Sleep ISOfix usage

- Only use iZi Sleep seats marked with 'APPROVED FOR ISOFIX' (mark on the bottom side). If there is no mark, the seat can not be used in combination with the ISOfix base. !



- Check the car manufacturers handbook for detailed information on ISOfix.
- For belt installation and product care see iZi Sleep manual.
- Without the ISOfix base the iZi Sleep can be installed with the car belt.

Positioning in car

- The iZi Sleep ISOfix is suitable for fixing into the seat positions of the cars listed in the carlist.

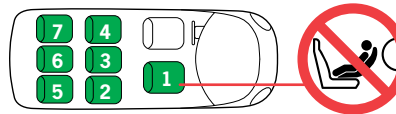

Rearward facing installation

- Only rearward facing installation allowed

ISOfix installation

!

- It is NOT ALLOWED to mount the seat in a front passenger seat WITH AN ACTIVATED AIRBAG.
- When installed with ISOfix: Make sure the indicators are green before you drive.
- The floor support must always be used. Make sure that the floor support is fully pushed down.



- 1- Click the insertion clips onto the ISOfix anchorage points on the vehicle seat (between seat and backrest) (1). The insertion clips should be removed when not in use.

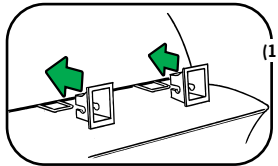

- 2- Release the floor support from underneath the base (2). Do this outside the car.

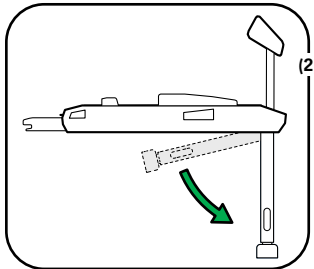

- 3- Position the base on the car seat. Click the ISOfix connectors in the ISOfix points on the vehicle seat. Make sure that both ISOfix indicators are green (3).

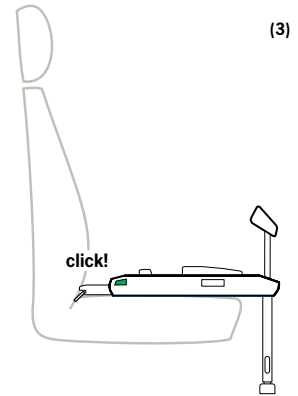

- 4- Unlock the height adjuster floor support and push the floor support down till it's in contact with the floor of the car (4).

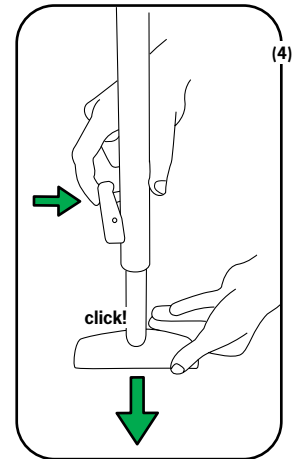

- 5- Position the iZi Sleep on the base (5). Check if the iZi Sleep release buttons are up and indicate green. If the button is not up and does not indicate green check if the floor support is folded out.

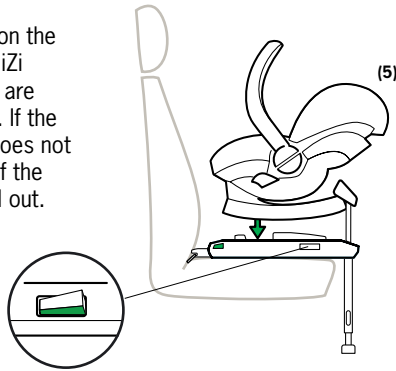

- 6- Move the carrying handle to the 'safe-to-drive' position by pushing the handle release buttons on the inside of the handle. Push the carrying handle towards the vehicle seat as far as possible. There are 2 safe-to-drive positions: A and B (6).

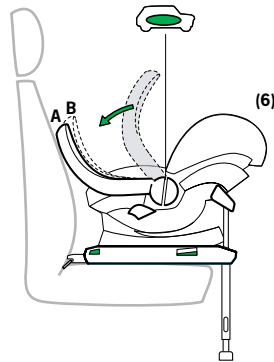

- 7- Check the 'safe-to drive' indication on the carrying handle, near the handle release button (7).

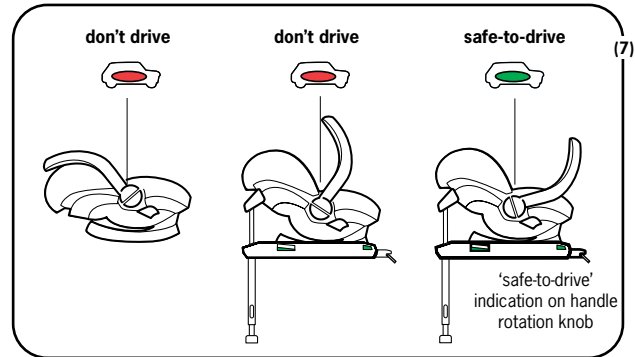

- 8- All 6 indicators (3 left and 3 right) must show green (8).

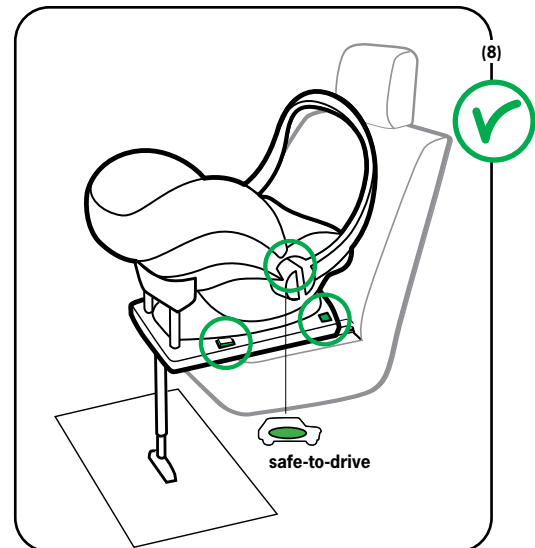

Removing iZi Sleep ISOfix

1- Move the carrying handle to the carrying position by pushing the handle release buttons on the inside of the handle (9).

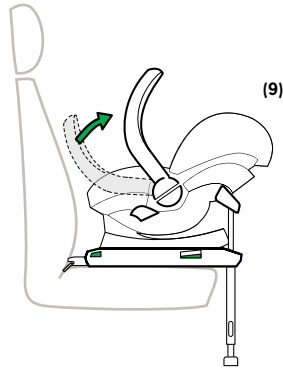

2- Remove the iZi Sleep while pressing one of the iZi Sleep release buttons (10).

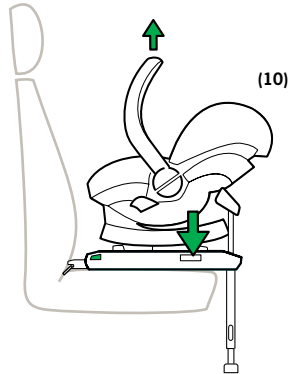

3- To release the ISOfix anchorages, pull the ISOfix release switches on both sides. Afterwards the indicators should show a red indication (11).

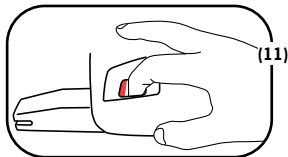

4- Unlock the height adjuster of the floor support and push the floor support fully up (12).

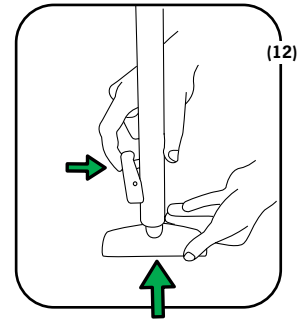

5- Take the iZi Sleep ISOfix base out of the car (13).

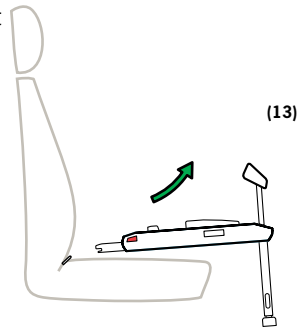

- 6- Store the floor support underneath the base (14).

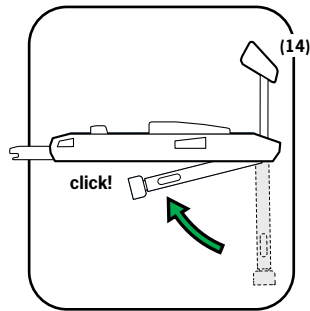

- 7- Remove the ISOfix insertion clips from the vehicle seat and store them underneath the base (15).

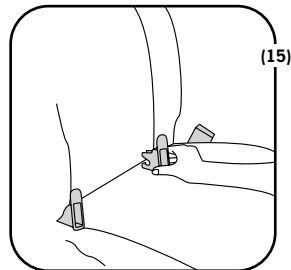

Warning: potential misuse

- It is NOT ALLOWED to mount the seat in a front passenger seat WITH AN ACTIVATED AIRBAG.



- DO NOT use the iZi Sleep with the carrying handle in carrying position. The handle must be in 'safe-to-drive' position showing green indications.



- DO NOT use the seat with folded floor support.



- DO NOT use the car belt in combination with iZi Sleep ISOfix base.



Important advice

- DO NOT attempt to dismantle, modify or add any part to the seat. Warranty will expire if non-original parts or accessories are used.
- DO NOT use anything, such as a cushion, to raise the child seat off the passenger seat of the vehicle. In an accident the seat will not be able to protect your child in the right way.
- Never leave your child unattended in the seat.
- Make sure all passengers are informed about how to release your child in case of emergency.
- An unoccupied child seat should always be fastened in the vehicle.
- Make sure luggage or other objects are properly secured. Unsecured luggage may cause severe injuries to children and adults in case of accidents.
- Never use the seat without the cover. The cover is a safety feature and may only be replaced by an original BeSafe cover.
- Under the cover we use EPS foam. Do not push or pull too hard against the foam, since you might damage the foam.
- Do not use any aggressive cleaning products; these may harm the construction material of the seat.
- BeSafe advises that child seats should not be bought or sold second-hand.
- KEEP this user manual for later use with the seat.
- DO NOT use the seat for longer than 5 years. Due to ageing, the quality of the material may change.
- DO NOT use at home on a table or worktop, as long as your child is seated in the seat.
- When installed with ISOfix: Check the manufacturer's vehicle handbook.

Practical advice

When the child seat is mounted in the car check all the areas where the child seat might touch the interior. We recommend using a (BeSafe) protection cover in these places to avoid cuts, marks or discolouration on the interior of the vehicle, especially in vehicles with leather or wooden interior.

Point of sale information

Notice for ISOfix installation

- This is a semi-universal ISOfix Child Restraint System. It is approved to regulation No. 44.04, series of amendments for general use in vehicles fitted with ISOfix anchorage systems.
- It will fit cars with positions approved as ISOfix positions (as detailed in the vehicle handbook), depending on category of the child seat and of the fixture.
- The mass group and the ISOfix size class for which this device is intended is: E.
- The seat is suitable for fixing into the seat positions of the vehicles listed in the separate 'car list'. Seat positions in other vehicles may also be suitable to accept this child restraint. If in doubt, consult either the child restraint manufacturer or the retailer. For updated car list see: www.besafe.eu.

Next car seat

- BeSafe offers several car seats suitable as from 9 kg. For updated car seat program see www.besafe.eu

Guarantee

- All BeSafe products are carefully designed, manufactured and tested. All of our BeSafe child seats are tested periodically out of our continuous production in our test laboratory. Furthermore they are tested by independent test institutes.
- Should this product prove faulty within 24 months of purchase due to materials or manufacturing fault, except covers and harness straps, please return it to the original place of purchase.
- The guarantee is only valid when you use your seat appropriately and with care. Please contact your dealer, he will decide if the seat will be returned to the manufacturer for repair. Replacement or return cannot be claimed. The guarantee does not get extended through repair.
- The guarantee expires: when there is no receipt, when defects are caused by wrong and improper use, when defects are caused by abuse, misuse or negligence.



HTS BeSafe as
N-3535 Krøderen, Norway - www.besafe.eu

BeSafe®